

## CHEM-TECH SERIES XP PERISTALTIC METERING PUMPS

The Chem-Tech Series XP with peristaltic technology delivers worry-free dosing in a modern design. Each and every component of the Series XP is designed and manufactured for optimum reliability and durability for REAL Performance.

The electronic timing circuit in the adjustable 'A' Models provides reliable pump control, without relying on mechanical adjustment components that wear out over time.

The intuitive interface and controls provide easy operation and the peristaltic design is virtually maintenance-free.

Tailor-made for the water conditioning market, the Series XP offer affordable solutions in both initial cost and operation.

A rugged gear train and computer-aided peristaltic design ensure long-lasting performance.



### FEATURES

- Fixed Models. Simple and straight forward fixed rate pumps for applications where economy and ease-of-use are required.
- Adjustable Models. Electronic timer module provides a 20:1 turndown control for enhanced flexibility.
- Pulse Input Models. Internal timer accepts pulses from a contacting head water meter. Adjustable to run the pumps from .1 to 1 sec., .2 to 10 sec., or from 1.0 to 60 sec. per pulse.
- Flow Switch Activated Models. Activated when flow rate through the included 3/4" NPT flow switch reaches 1 GPM and deactivated when flow rate is less than 1 GPM.
- Dry Contact Input Models. Activates pump upon closure of a dry contact switch, and deactivates when opened. Pump equipped with a 6' lead for connection to the customer supplied switch.
- Timer Models. 7 Day – 8 Event Electronic Timer.
- Duplex Head Models. Two pump heads to deliver twice the flow, or the rated flow of two different chemicals simultaneously.
- Tubing Materials. Standard Norprene tube material in Low Pressure ratings - extended tube life, High Pressure ratings - meet demanding system requirements. Fluran tubing - greater chemical resistance: contact Technical Service for compatibility.

### BENEFITS

- Reliable metering performance.
- Mixed fluid capable. Inherently degassing.
- Extended tube life.
- Rugged, sealed gear train.
- Easy tube change-out.
- Self priming.
- Chemical resistant materials.
- Simple installation



Intertek  
9700150



Intertek  
9700150

Tested and Certified by WQA  
against NSF/ANSI/CAN 61 & 372.



Chem-Tech Series XP & XPV Pumps.  
See [www.wqa.org](http://www.wqa.org) for  
certification parameters.

## MODEL SELECTION

Model	Flow	Pressure Rating - PSI (BAR)				Tube Size	Speed (RPM)
		Single Head Options			Duplex		
		"H" Tube	"L" Tube	"F" Tube	"L" Tube		
XP004	4 GPD (0.6 LPH)	125 (8.6)	80 (5.5)	60 (4.1)	80 (5.5)	2	30
XP007	7 GPD (1.1 LPH)				50		
XP009	9 GPD (1.4 LPH)	110 (7.6)	70 (4.8)	50 (3.4)	70 (4.8)	3	30
XP015	15 GPD (2.4 LPH)				50		
XP014	14 GPD (2.3 LPH)	100 (5.9)	50 (3.4)	40 (2.8)	50 (3.4)	4	30
XP023	23 GPD (3.6 LPH)				50		
XP030	30 GPD (4.7 LPH)	80 (5.5)	40 (2.8)		40 (2.8)	6	30
XP050	50 GPD (7.9 LPH)				50		
XP048	48 GPD (7.5 LPH)	25 (1.7)			25 (1.7)	8	30
XP080	80 GPD (12.6 LPH)				50		

## ENGINEERING DATA

Drive		Tubing	
Fixed Rate	On, Off Only	Norprene Low Pressure	1/4" or 3/8" Tube Fittings
	Duplex Head	Norprene High Pressure	1/4" or 3/8" Tube Fittings
	Dry Contact Input	Fluran	1/4" or 3/8" Tube Fittings (Does not include strainer & Injector accessories)
	Flow Switch Activated		
	7 Day - 8 Event Electronic Timer		
Adjustable	20:1 Turndown	Viscosity Max CPS	300 CPS
	Duplex Head	Enclosure	NEMA 3R / IP31 (In Horizontal Position)
	Dry Contact Input	Power Input	115 VAC/60 HZ, 1/6 HP
	Flow Switch Activated		230 VAC/50/60 HZ*
Pulse Input	.1 to 1 Second Timer		230 VAC/60 HZ
	.2 to 10 Second Timer	Temperature Limitations	104°F / 40°C max.
	1 to 60 Second Timer	Shipping Weight	8 lbs. / 3.63kg.
		Approvals	Conforms to ANSI/NSF STD. 50 Equipment for swimming pools, spas, hot tubs, and other recreational water facilities.

## DIMENSIONS All dimensions are in inches

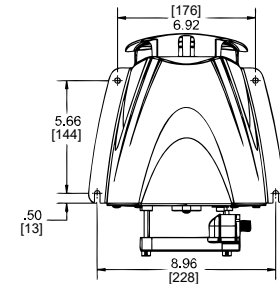
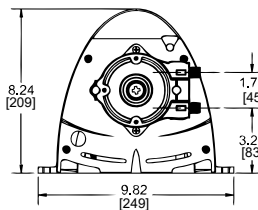
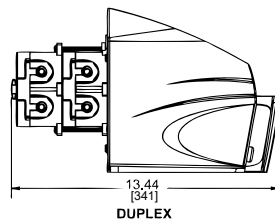
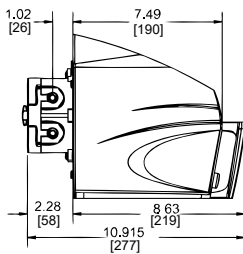

\*50 HZ: Rated for intermittent duty only. Continuous duty is not recommended.



27101 Airport Road  
Punta Gorda, FL 33982  
Tel: (941) 575-3800  
Fax: (941) 575-4085  
[www.pulsatron.com](http://www.pulsatron.com)



An ISO Certified Company



**WTS** | Water Treatment Supply

sales@watertreatmentsupply.com  
Office: 954-772-2129  
[www.watertreatmentsupply.com](http://www.watertreatmentsupply.com)